

FOLDING POCKET DOOR SYSTEM (INSET)

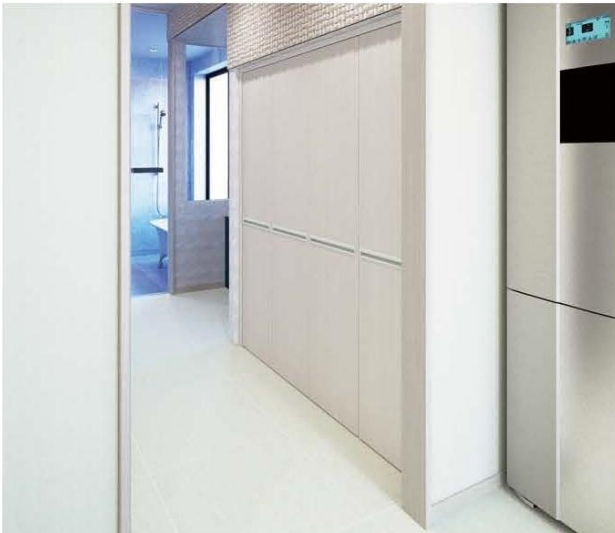

ALT-F



Door Width	Max. 450 mm
Door Height	Max. 1830 mm
Door Thickness	23 ~ 30 mm
Door Weight	Max. 10 kg/Door

By using additional parts, Door Height Max 2400mm(Max 10kg/Door) possible. Please contact us for the details.

■Features

Folding door is stored inside the cabinet.

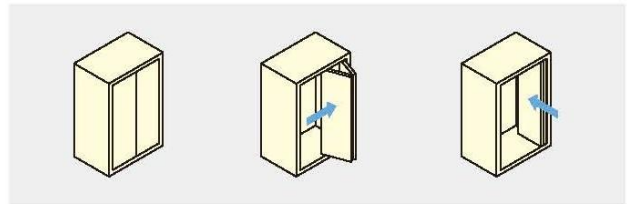

■Top View

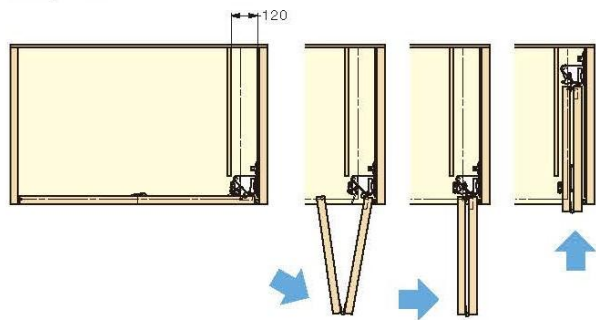

■Installation

Door storing
355.6(ALT-F18)
406.4(ALT-F20)

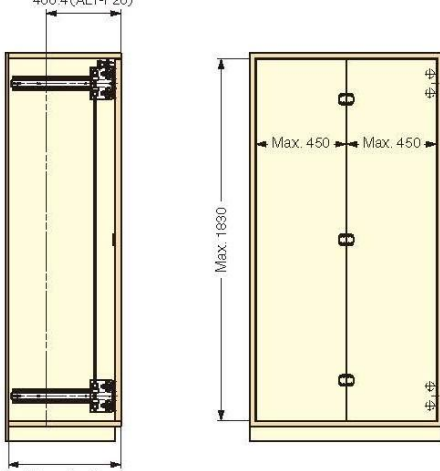

Min. cabinet depth
Min. 466.7 + Door thickness (ALT-F18)
Min. 517.5 + Door thickness (ALT-F20)

■Rail Dimensions

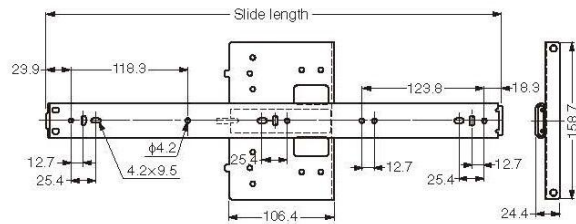

Item Name	Opening	Rail Length	Door Storing	Cabinet Depth
ALT-F18L	Left Opening	460.4	355.6	Min. 466.7 + Door Thickness
ALT-F18R	Right Opening	460.4	355.6	Min. 466.7 + Door Thickness
ALT-F20L	Left Opening	511.2	406.4	Min. 517.5 + Door Thickness
ALT-F20R	Right Opening	511.2	406.4	Min. 517.5 + Door Thickness

Parts Set

Necessary Parts

Please refer to "Qty [a] ~ [d]" for parts included in each set.

Set Name	Item Code	Item Name
a Left Opening (Door Storing 355.6)	180-034-183	ALT-F18L
b Right Opening (Door Storing 355.6)	180-034-184	ALT-F18R
c Left Opening (Door Storing 406.4)	180-034-185	ALT-F20L
d Right Opening (Door Storing 406.4)	180-034-186	ALT-F20R

Parts Included

No.	Qty	Part Name	Dimensions	Description
1	2 pcs	Rail	See P.614	<ul style="list-style-type: none"> Material: Steel Finish: Black Chromate
2	2 pcs	Rack		<ul style="list-style-type: none"> Material: ABS Finish: Black
3	1 pc	Cap		<ul style="list-style-type: none"> Material: Steel Finish: Black Chromate
4	4 pcs	Gear		<ul style="list-style-type: none"> Material: POM Finish: Black
5	4 pcs	Bush		<ul style="list-style-type: none"> Material: POM Finish: Black
6	4 pcs	Stationary Block		<ul style="list-style-type: none"> Material: POM Finish: Black <p>Screw : Binding Head Self Tapping Screw UNC8-32</p>
7	2 pcs	Not for ALT-F. This part is not used.		<ul style="list-style-type: none"> Material: PA Finish: Black <p>Screw : Countersunk Head Tapping Screw 4.2x32</p>
8	1 pc	Upper Rail Joint		<ul style="list-style-type: none"> Material: POM Finish: White
9	1 pc	End Guide		<ul style="list-style-type: none"> Material: Steel (SPCC) / POM Finish: Yellow Zinc Chromate / Natural
10	1 pc	Angle Stopper		<ul style="list-style-type: none"> Material: Steel (SPCC) Finish: Nickel

No.	Qty	Part Name	Dimensions	Description
11	1 pc	Inner Guide		<ul style="list-style-type: none"> Material: POM Finish: White
12	1 pc	Interlock		<ul style="list-style-type: none"> Material: Steel / POM Finish: Black / White <p>Flight type shown.</p>
13	3 pcs	Centre Hinge		<ul style="list-style-type: none"> Material: Steel Finish: Black <p>Screw : Countersunk Head Tapping Screw 3.5x16</p>
14	1 pc	Hinge Cover Bracket		<ul style="list-style-type: none"> Material: Steel (SPCC) Finish: Black Paint
15	2 set (4 pcs)	Hinge Set		<p>Item Code : 180-026-432 Item Name : ALT-F006HKEZX</p> <ul style="list-style-type: none"> Material: Steel / Zinc Alloy Finish: Yellow Zinc Chromate / Black

Rail

Necessary Parts

1 pc is necessary for a pair of doors.

No.	Qty	Item Code	Part Name	Dimensions	Description
16	1 pc	250-017-148	Upper Rail (1820 mm)		<ul style="list-style-type: none"> Material: Aluminium Finish: Anodized Silver <p>Bore Pitch : Approx. 300 mm Pitch End : Approx. 30 mm</p>
17	1 pc	250-019-971	Bottom Guide Rail (1500 mm)		<ul style="list-style-type: none"> Material: Aluminium Finish: Anodized Silver

Shaft

Necessary Parts

1 pc is necessary for a pair of doors.

No.	Length	Qty	Item Code	Part Name	Dimensions	Description
18	902±13 mm	1 pc	180-121-047	Shaft		<ul style="list-style-type: none"> Material: Steel Finish: Black Chromate
			Item Name 29475-36			
19	1207±13 mm	1 pc	180-121-048			
			Item Name 29475-48			
20	1816±13 mm	1 pc	180-121-049			
			Item Name 29475-72			